

REVISONS						
ZONE	LTR	DESCRIPTION	ECN NO.	DATE	BY	APPR'D
	REL	RELEASED FOR PRODUCTION	DR17627 71349	21JAN08	SLK	DJC
1A	A	AI 131.0 WAS 138.0	DR17646 71404	12FEB08	SLK	CD
2B	B	BI CHANGED FLOW WIRE	DR19344	30APR08	SLK	DJC
2B	C	UP1 ASSEMBLY TO PUMP CAPSTONE COVER PLATE DESIGN	DR23287			
4D	C	C2 ADD CONNECTOR P/INOUT FIELDS C3 RV0000316 WAS RV0000318 C4 TU030 WAS FM0002087	71893 71949	15MAY09	WDE	DJC
4A	D	DI REPLACED "HOT STAMP MARKING INFO"	73288	25JAN11	SNB	DJC

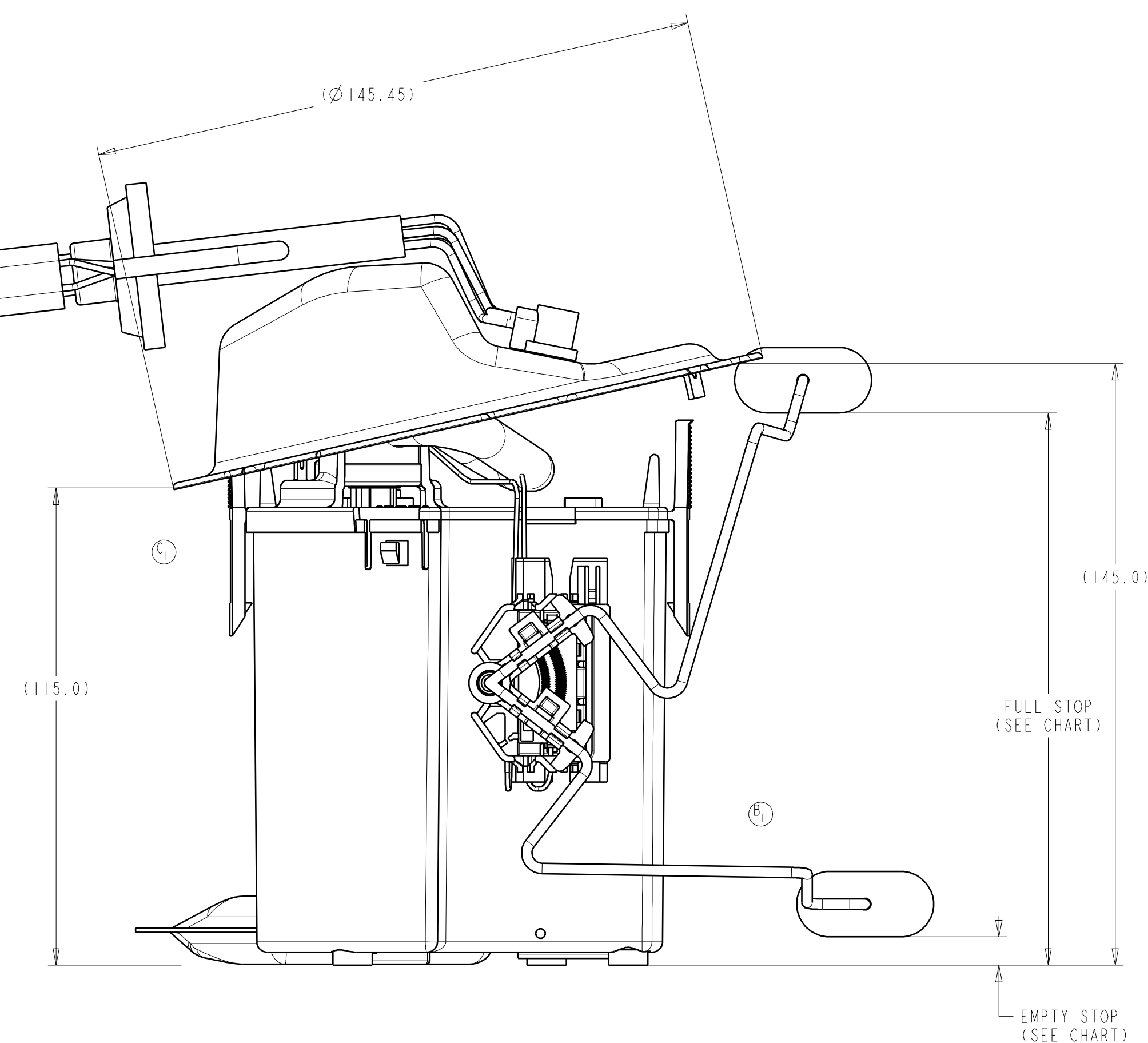
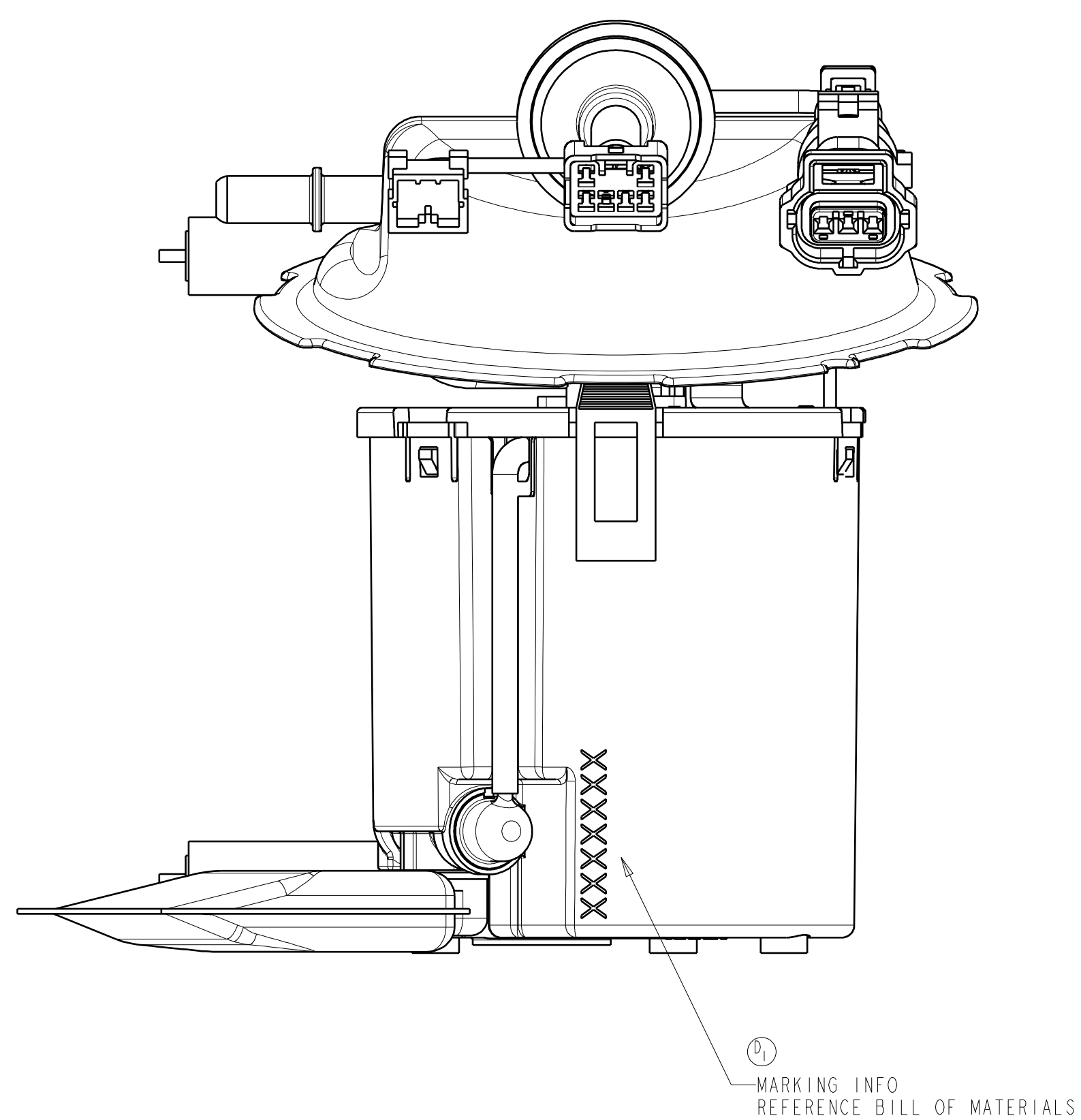
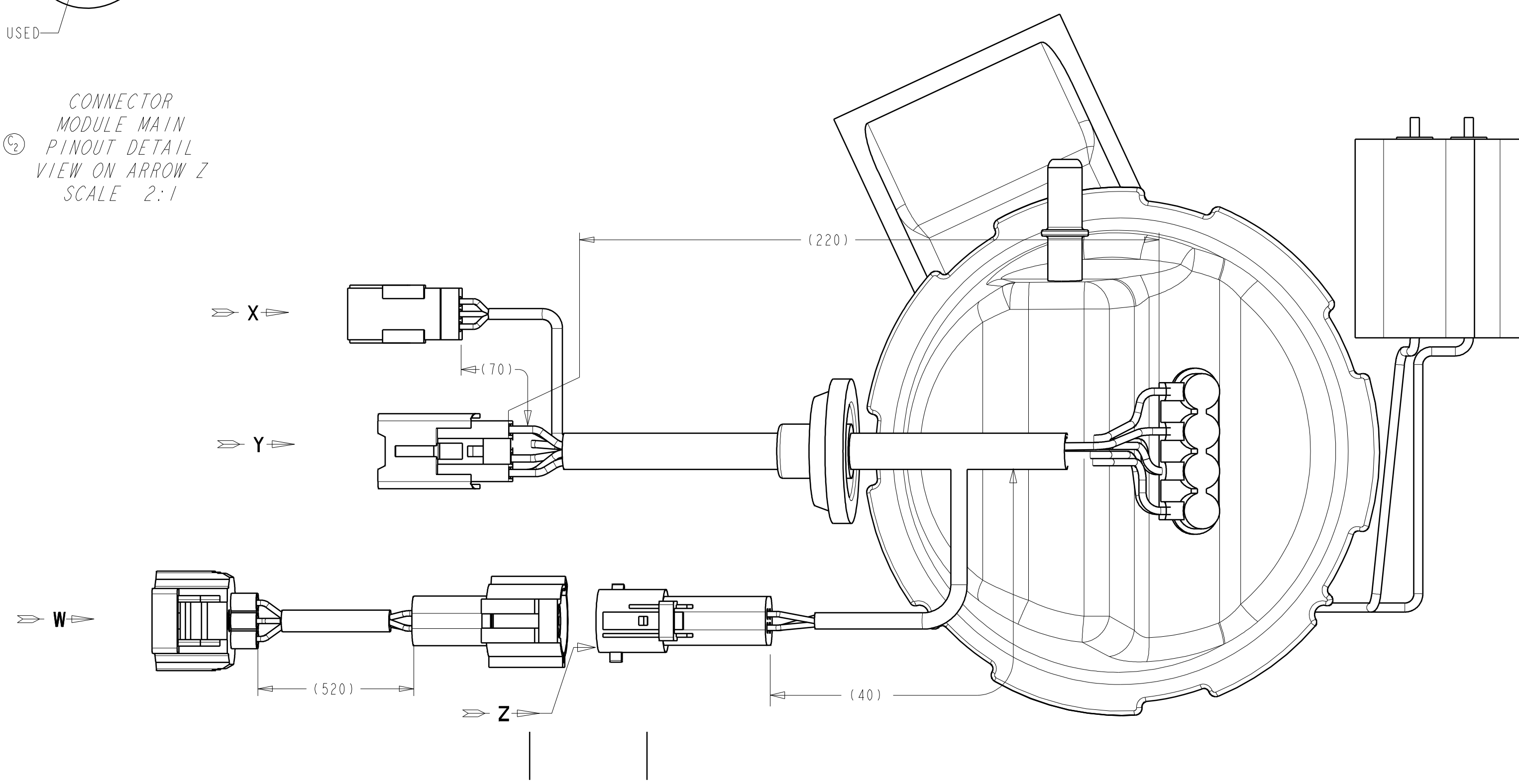
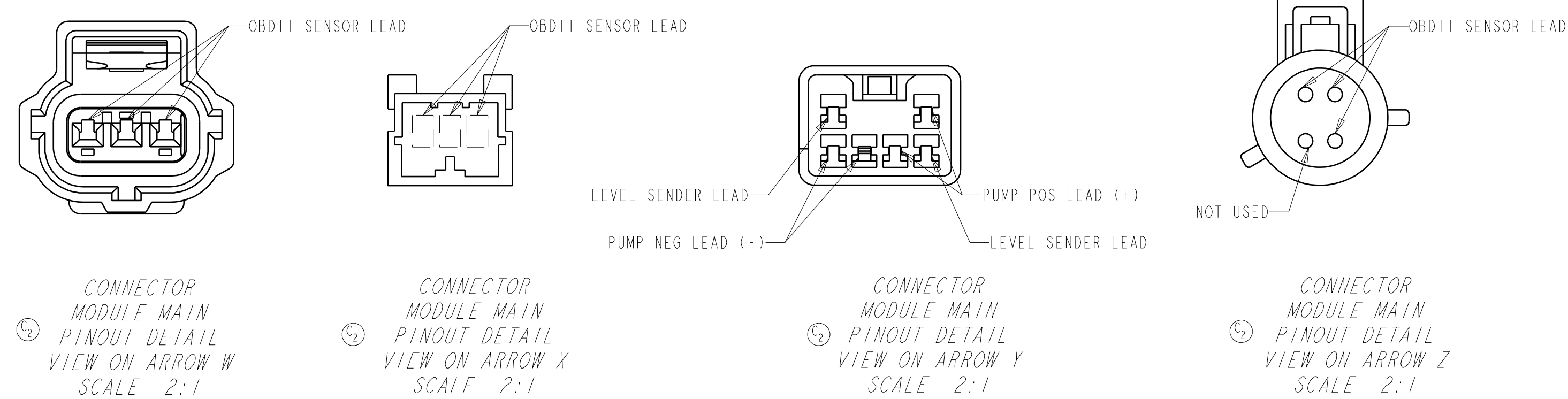

	FLOAT POSITION	RESISTANCE (OHMS)
(A ₁)	FULL STOP (131.0)	160.5±3.0
	EMPTY STOP (3.0)	15±1

NOTE:

1. SPECIAL CUSTOMER PACKAGING REQUIREMENTS MAY CALL FOR THE ADDITION OF SPECIFIC LABELS NOT SHOWN ON THIS DRAWING.
2. SHOWN WIRE ROUTING MAY DIFFER FROM FINISHED PRODUCT.
3. SHOWN RESISTOR CARD AND PUMP TERMINATION MAY DIFFER FROM FINISHED PRODUCT.

INTERNAL USE ONLY DISTRIBUTION CODE		<i>TI Automotive</i>		AFPMARKET DIVISION 630 COLUMBIA STREET CARO, MICHIGAN 48723	
REF. FMO002087		E	TOL. RANGE UNLESS OTHERWISE SPECIFIED	MATERIAL	DATE 1-1-21
DO NOT SCALE PRINT		SIZE 4	±0.007 ±0.005 ±0.003 ±0.002	FINISH	21 JAN 2021
DIMENSIONS AND TOLERANCES PER ANSI Y14.5M-1994			ANGLE CONCERN		DES. BY S. KADY CHKD BY S. KADY
PROJ. PROJECTION		TITLE FUEL MODULE OUTLINE		DRAWING NO. TU230	
				REV.	